

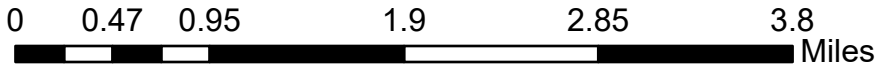

Volunteer Wildlife Monitoring Program (VWMP) Frog and Toad Survey

Inactive Route Map Route ID: 166 County: Clarke

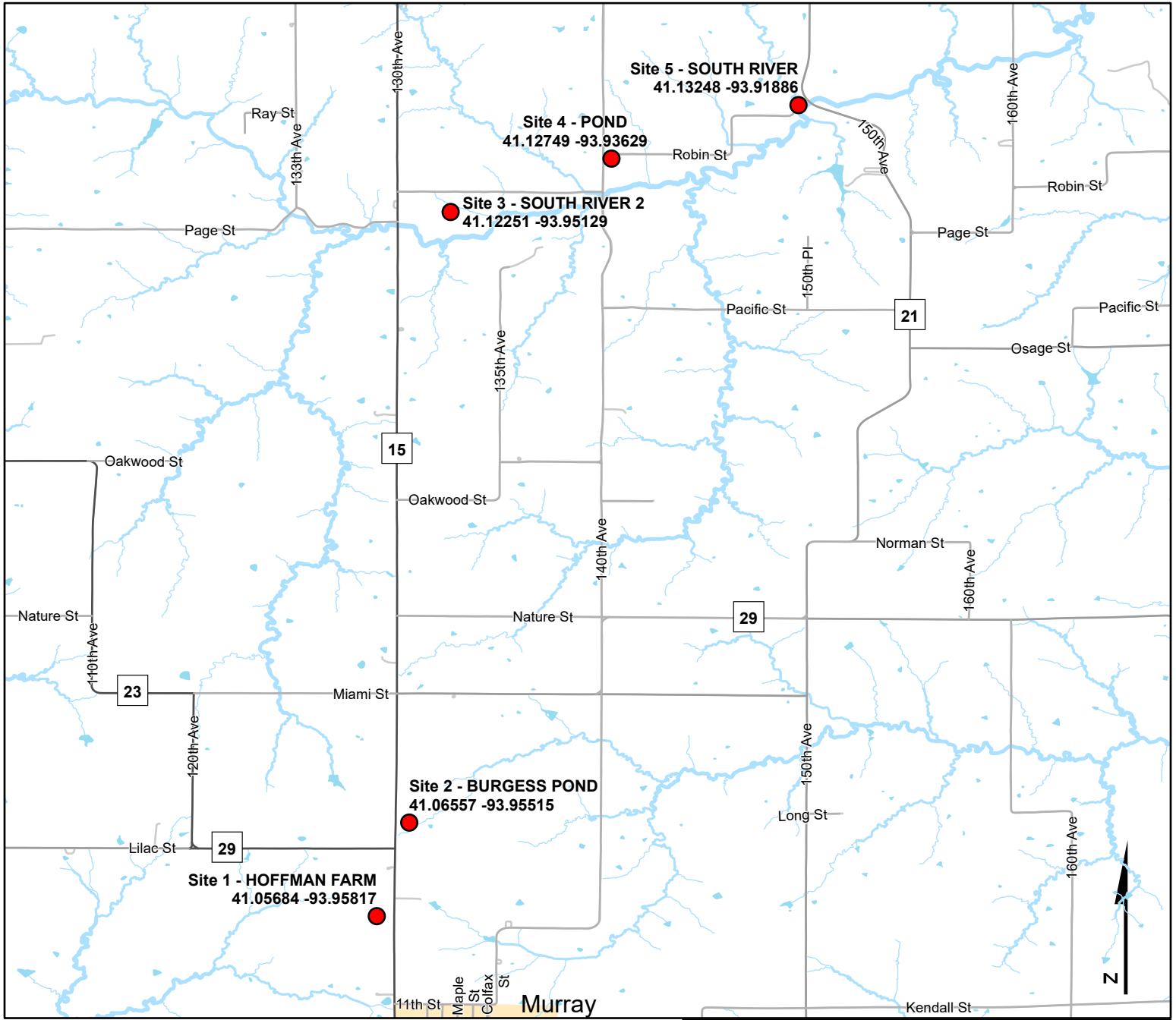

● Frog and Toad Survey Sites



Questions? Contact the VWMP Coordinator at wvmp@dnr.iowa.gov.

Created on: 4/4/2019

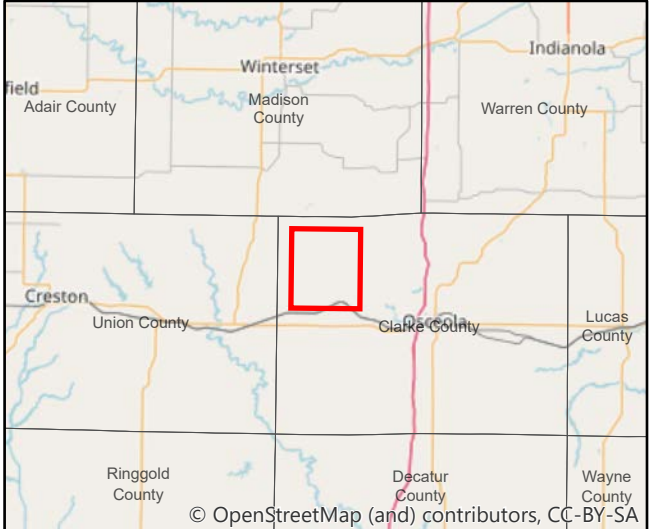

© OpenStreetMap (and) contributors, CC-BY-SA



Volunteer Wildlife Monitoring Program (VWMP) Frog and Toad Survey

Inactive Route Table Route ID: 166 County: Clarke



SiteNum	Site_Name	Directions
1	HOFFMAN FARM	Just north of house 100 ft. -Hoffman Farm
2	BURGESS POND	0.5 mile north of site 1, Right side of R15
3	SOUTH RIVER 2	Map and directions do not match.
4	POND	0.25 mile north of R 15 bridge over South river - on east side of road.
5	SOUTH RIVER	